



est. 1987
MagnoliaHOMES

CYPRESS GROVE

The Chateau

HOME SITE 261



Cypress Grove

HOME SITE 261

872 CYPRESS ROCK LANE
COLLIERVILLE, TN 38017

HEATED SQ. FT. 4189-4389
SQ. FT. UNDER ROOF 5282-5482

5 BEDROOMS
2 BEDROOMS DOWN
4 FULL BATHROOMS
HALF BATH DOWN
GAME ROOM UPSTAIRS
COVERED REAR PORCH
SIZABLE 3 CAR GARAGE
VAULTED 2-STORY FAMILY ROOM
OFFICE/PRAYER ROOM DOWN
SCULLERY WITH SINK OFF OF KITCHEN
10' CEILINGS DOWN & 9' CEILINGS UP

Included:

- JAMES HARDIE® (NO ROT) SIDING WITH A 30 YR. MANUFACTURER LIMITED WARRANTY, EXTERIOR TRIM HAS A 15 YR. LIMITED WARRANTY; PER PLAN. SIDING SEEN FROM THE STREET WITH MITERED CORNERS
- JELD-WEN® WINDOWS ARE LOW-MAINTENANCE BRICKMOULD VINYL FRAMED WINDOWS! NO MORE PAINTING! LOW-E ADVANCED GLASS & ARGON GAS IN ALL WINDOWS. GBG WINDOWS ON FRONT OF HOME & WINDOWS FACING STREET.
- AMANA® EQUIPMENT USED FOR HVAC, LTD. LIFETIME WARRANTY ON COMPRESSOR AND HEAT EXCHANGE WITH 10 YR. PARTS FOR THE ORIGINAL HOMEOWNER.
- 10 YEAR LIMITED WARRANTY BY QUALITY BUILDERS WARRANTY CORPORATION; BACKED BY LIBERTY MUTUAL®
- 42" BRICK FIREPLACE IN FAMILY ROOM WITH BRICK VENEER AND CEDAR MANTEL
- BUILT-IN ON SIDE OF FIREPLACE WITH BASE CABINETS & CEDAR SHELVES
- CUSTOM BUILT VENT HOOD IN KITCHEN
- DOUBLE CONVECTION OVENS IN KITCHEN WITH STACKED MICROWAVE
- APRON FRONT WHITE FARM SINK IN KITCHEN
- FREE STANDING TUB IN PRIMARY BATH
- SHAMPOO BOXES IN PRIMARY AND SECONDARY BATHROOMS
- CROWN MOLDING THROUGHOUT THE HOME
- CEILINGS THROUGHOUT THE HOME ARE SMOOTH



est. 1987
MagnoliaHOMES

CYPRESS GROVE

The Chateau

HOME SITE 261

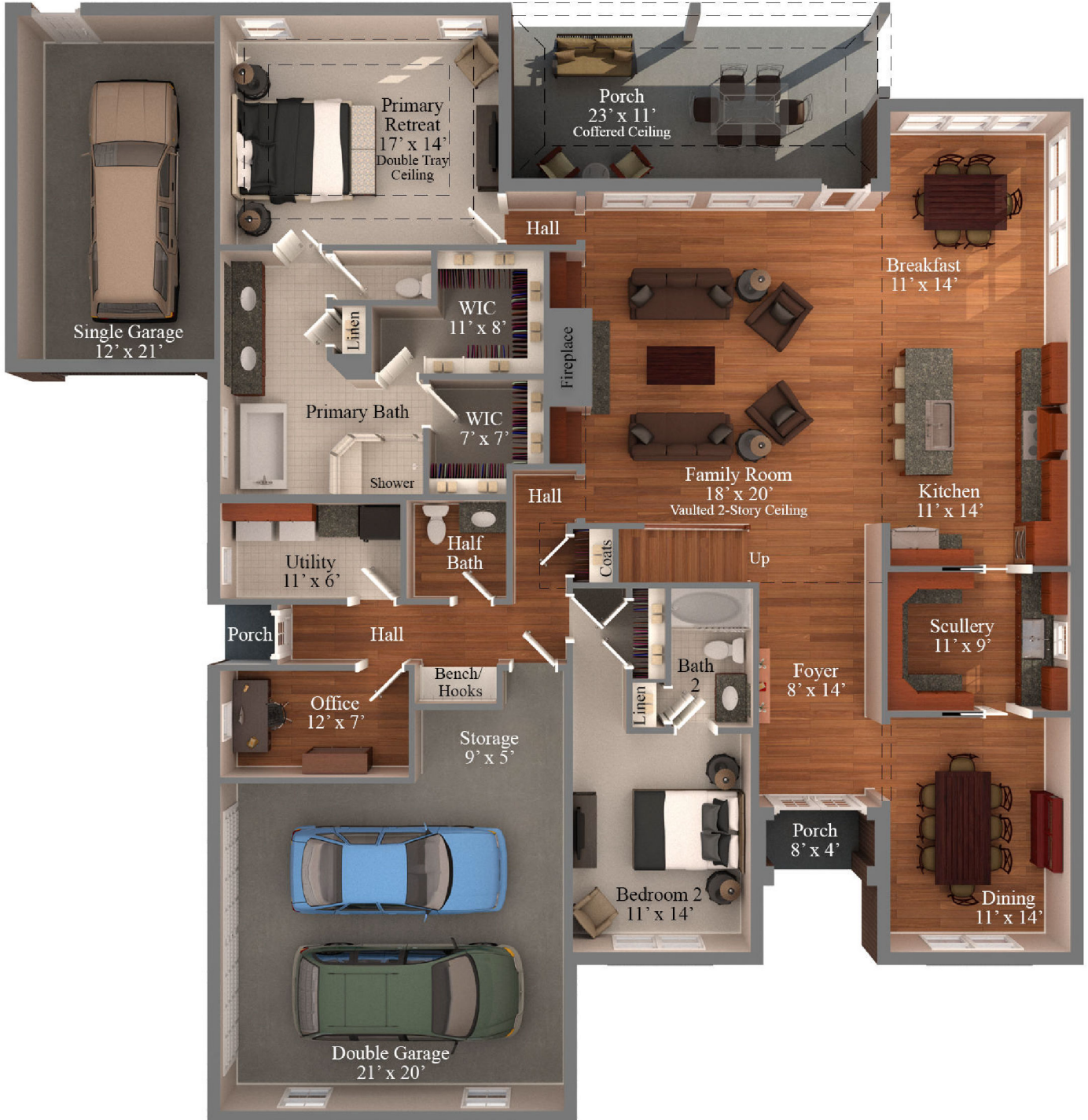

First Floor: 10' Ceilings unless noted

