



MagnoliaHOMES est. 1987

VILLAGES OF SAUNDERS CREEK

The Latham Farmhouse

BASE PLAN



Elevation A

Villages of Saunders

Included:

HEATED SQ. FT. 3489-4005
SQ. FT. UNDER ROOF 4245-4961

- VAULTED CEILING IN FAMILY ROOM
- 3 BEDROOMS INCLUDED
- 2 BEDROOMS DOWN
- 3 FULL BATHROOMS
- FUTURE 4TH BEDROOM UP
- GAME ROOM UPSTAIRS
- LARGE OVERSIZED GARAGES
- LARGE COVERED REAR PORCH

Included:

- 10 YEAR LIMITED WARRANTY BY QUALITY BUILDERS WARRANTY CORPORATION; BACKED BY LIBERTY MUTUAL®
- JAMES HARDIE® (NO ROT) SIDING WITH A 30 YR. MANUFACTURER LIMITED WARRANTY, EXTERIOR TRIM HAS A 15 YR. LIMITED WARRANTY; PER PLAN.
- JELD-WEN® WINDOWS ARE LOW-MAINTENANCE BRICKMOULD VINYL FRAMED WINDOWS. LOW-E ADVANCED GLASS & ARGON GAS IN ALL WINDOWS. GBG WINDOWS ON ALL WINDOWS ON HOME, INCLUDING SIDES AND REAR OF HOME.
- TYVEK® HOUSE WRAP WITH 10 YR. LIMITED WARRANTY
- AMANA® EQUIPMENT USED FOR HVAC, LTD. LIFETIME WARRANTY ON COMPRESSOR AND HEAT EXCHANGE WITH 10 YR. PARTS FOR THE ORIGINAL HOMEOWNER.



Optional Built-Ins
Location

Optional Butler's
Pantry Location

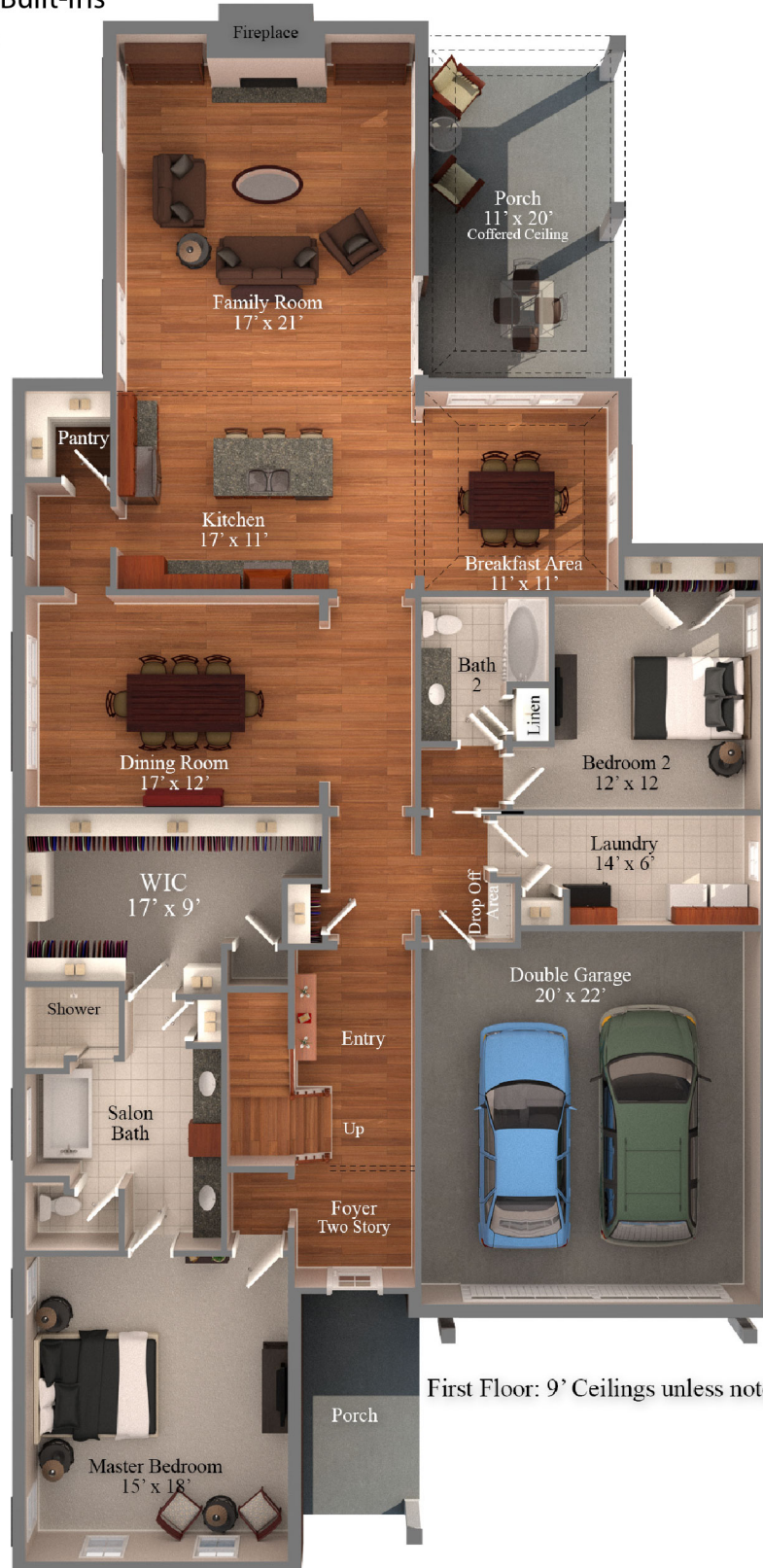

First Floor: 9' Ceilings unless noted

