



est. 1987  
**Magnolia**HOMES

VILLAGES OF SAUNDERS CREEK

# The Chateau Margaux plan



ELEVATION A



ELEVATION B



*Villages of Saunders*

HEATED SQ. FT. 3276-3526  
SQ. FT. UNDER ROOF 3936-4386

11' CEILING IN FAMILY ROOM\*  
4 BEDROOMS INCLUDED  
2 BEDROOMS DOWN  
3 FULL BATHROOMS  
GAME ROOM UPSTAIRS  
LARGE DOUBLE GARAGE  
2 STORY FOYER  
LARGE COVERED REAR PORCH

### *Available options to add:*

- OPTIONAL THIRD CAR GARAGE
- OPTIONAL HALF BATH
- OPTION TO EXPAND BEDROOM 2

### *Included:*

- JAMES HARDIE® (NO ROT) SIDING WITH A 30 YR. MANUFACTURER LIMITED WARRANTY, EXTERIOR TRIM HAS A 15 YR. LIMITED WARRANTY; PER PLAN.
- PELLA® WINDOWS ARE LOW-MAINTENANCE VINYL FRAMED WINDOWS = NO MORE PAINTING. LOW-E ADVANCED GLASS & ARGON GAS IN ALL WINDOWS. SDL WINDOWS ON FRONT OF HOME & WINDOWS FACING STREET.
- AMANA® EQUIPMENT USED FOR HVAC, LTD. LIFETIME WARRANTY ON COMPRESSOR AND HEAT EXCHANGE WITH 10 YR. PARTS FOR THE ORIGINAL HOMEOWNER.
- 10 YEAR LIMITED WARRANTY BY QUALITY BUILDERS WARRANTY CORPORATION; BACKED BY LIBERTY MUTUAL®



est. 1987  
**Magnolia**HOMES

VILLAGES OF SAUNDERS CREEK

# The Chateau Margaux plan

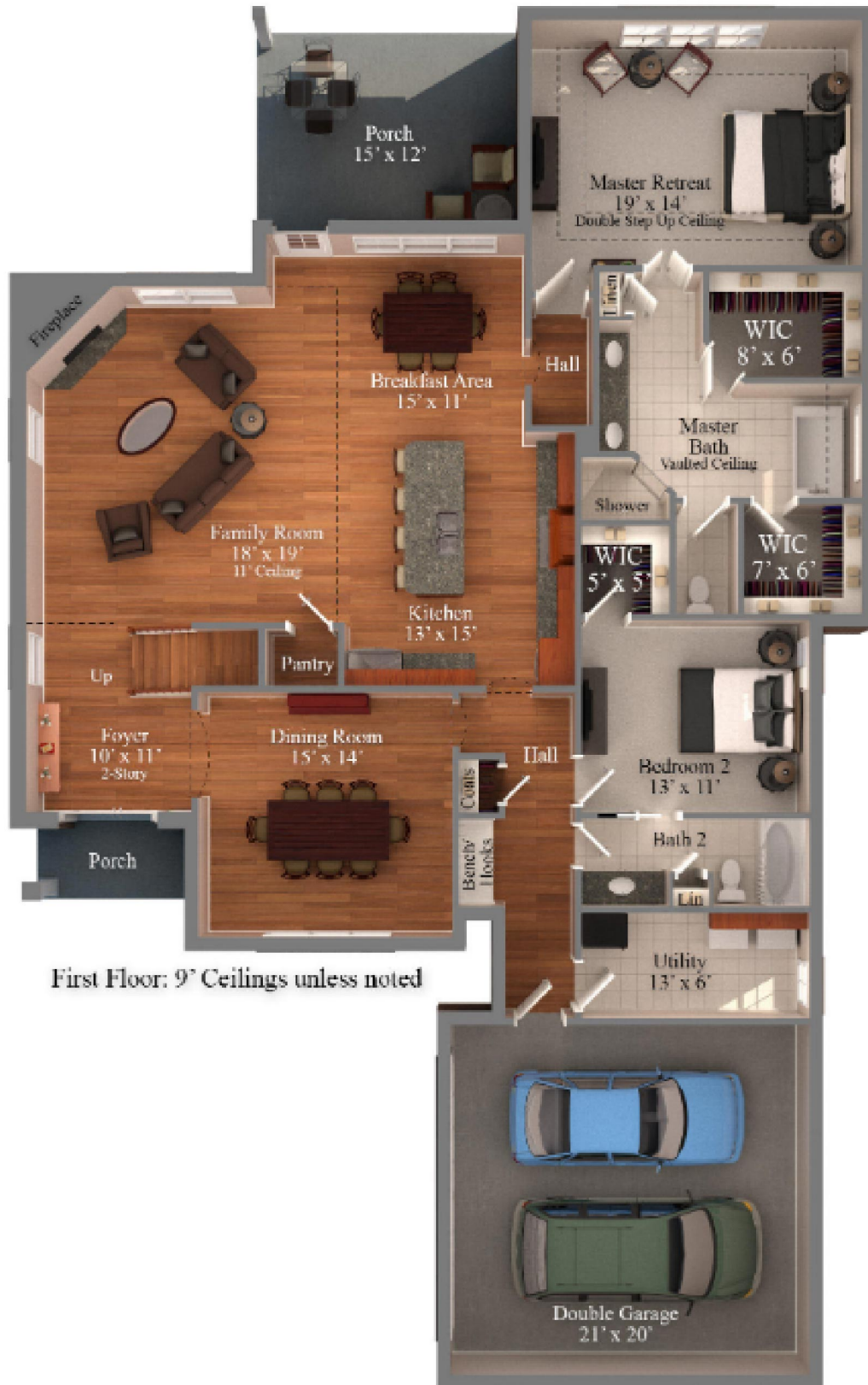



est. 1987  
**MagnoliaHOMES**

VILLAGES OF SAUNDERS CREEK

# The Chateau Margaux plan





est. 1987  
**MagnoliaHOMES**

VILLAGES OF SAUNDERS CREEK

# The Chateau Margaux plan

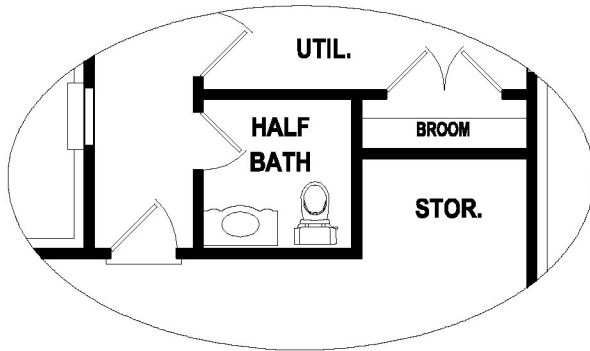

**"OPTIONAL"  
HALF BATH**

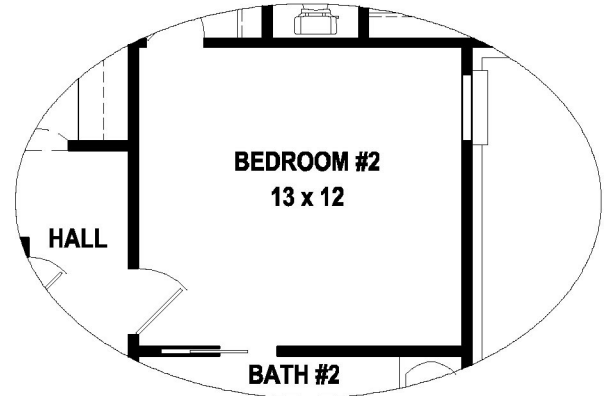

**"OPTIONAL"  
EXPANDED BEDROOM #2**

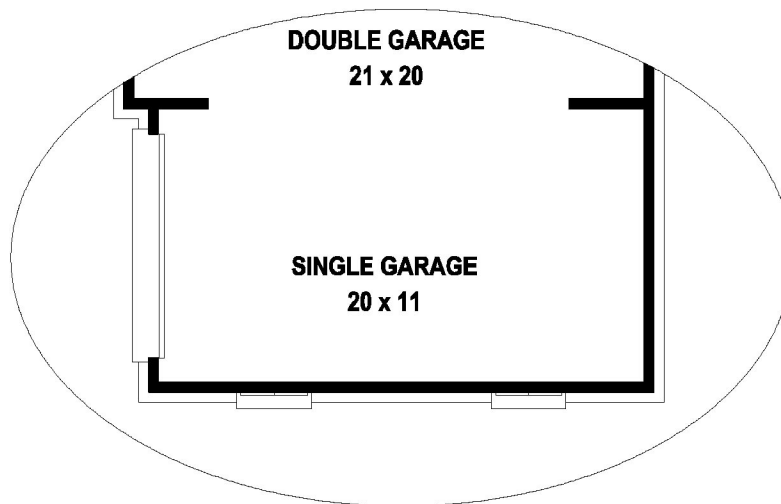

**"OPTIONAL"  
TRIPLE GARAGE**